

**RONDO®**

**Steel Stud  
Drywall Framing Systems**

steel framing installation guide



# RONDO

## STEEL STUD & TRACK SECTIONS

### GENERAL INFORMATION

Rondo Steel Stud Drywall Framing Systems provide designers with a versatile and durable framing system, manufactured to Australian and New Zealand Standards. Rondo recommends that you check you are referring to the latest edition by comparing this to the one currently available on our website, [www.rondo.com.au](http://www.rondo.com.au)

### FEATURES & BENEFITS

FEATURE	BENEFIT
<b>Code Compliance</b>	Rondo Steel Stud and Track Sections are manufactured to enable designs to be carried out in accordance with the BCA and appropriate Australian and New Zealand Standards. The design tables have been designed to comply with AS/NZS 4600:1996 for cold formed steel structures.
<b>Rondo Guarantee</b>	When installed correctly, Rondo guarantees in writing that its products and systems will perform to specification. NOTE: Mixing of different manufacturers systems is not recommended by Rondo and as such is not covered by the Rondo Guarantee.
<b>Superior Design</b>	The Rondo Steel Stud and Track profile designs have been tested to give maximum performance when installed.
<b>Quality Assurance</b>	The Rondo Steel Stud and Track range is produced using highly advanced, state-of-the-art manufacturing processes by a manufacturer who has been in the business for over 50 years, using a quality management system certified to ISO 9001 standards.
<b>Technical Expertise</b>	For detailed technical information, visit <a href="http://www.rondo.com.au">www.rondo.com.au</a> to view the Rondo Professional Design Manual, use the online Rondo Wall Design Wizard, view the Stud & Track installation video, download the Rondo App, or obtain a technical resource USB from your Authorised Rondo Distributor. For all other technical advice, such as load-bearing walls or seismic design, contact your local Rondo Technical Sales Representative.
<b>Time-saving and Economical</b>	Drywall Steel Framing systems are approximately 88% lighter than a 110mm single brick rendered wall. Bell-mouthed service holes at 600mm centres do not require grommets for cabling. Stock and sub-pack quantities are strapped for easy lifting by crane/forklift or manually.
<b>Sound and Fire-Rating Solutions</b>	Construction of fire-rated walls can be achieved using the appropriate systems and accessories provided. Refer to the technical literature published by the respective lining board manufacturer for more detailed instructions on designing & installing fire-rated or sound rated drywall systems.

### RONDO STUD & TRACK SECTIONS

#### WALL STUDS

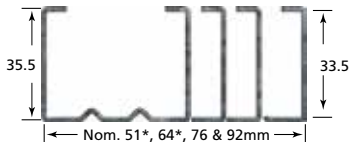

0.50/0.55 BMT



0.75 BMT



1.15 BMT

#### WALL TRACKS

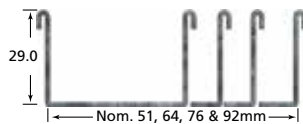

0.50/0.70 BMT

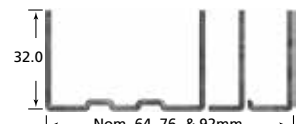

1.15 BMT

#### DEFLECTION HEAD TRACKS

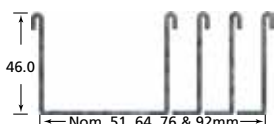

0.50/0.70 BMT



0.75/1.15 BMT

#### NOGGING TRACK

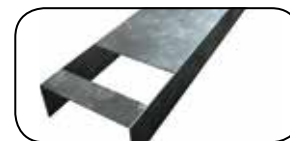

Nom. 51, 64, 76, 92 & 150mm

# RONDO STEEL STUD & TRACK INSTALLATION

## 1. SYSTEM SELECTION

Using Table 1 below, choose the stud appropriate to your wall height and the lining board you desire to use. Then select tracks to match size and gauge of chosen studs.

## 2. NOGGINGS

Using Table 2, determine the nogging requirements for the wall. The continuous Nogging Track can be installed by sitting the track flat over the floor track while studs are fitted, and then slide the nogging track up over the studs. Screw fix the nogging to both sides of the stud at the point of intersection. Refer Figure 4.

## 3. SET OUT AND INSTALLATION

Install the floor and ceiling track to suit your wall layout and secure to the structure at no less than 600mm centres internally, and 100mm from ends. For information on the appropriate fixings, consult your Authorised Rondo Distributor.

## 4. INSERT WALL STUDS

Insert Wall Studs into Wall Tracks at the appropriate position as per Figure 4, ensuring all studs are facing the same way. Wall studs are designed to be friction fitted into the tracks, and are installed using a twisting action. Ensure service holes in studs are aligned. Studs are braced by the application of the lining board, so do not require permanent fixing.

## 5. INTERSECTIONS

Figures 1 & 2 show typical wall intersections whilst Figures 5 & 6 show typical ceiling intersections. For more complex connections, refer to the Rondo website or consult your Authorised Rondo Distributor.

## 6. CONTROL JOINTS

Plasterboard manufacturers recommend control joints be installed in continuous walls at not more than 12m. Refer Figure 3.

## 7. PLASTERBOARD LINING

While plasterboard manufacturers should be consulted about linings, it is critical that lining boards be installed to the open side of the stud first to ensure misalignment of joints does not occur in vertical fixing applications.

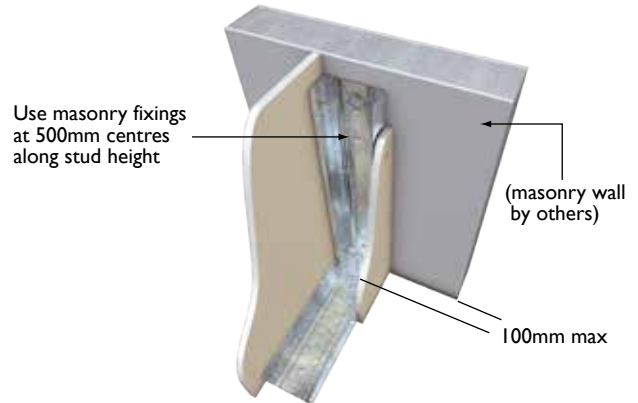

FIGURE 1: INTERSECTION – MASONRY

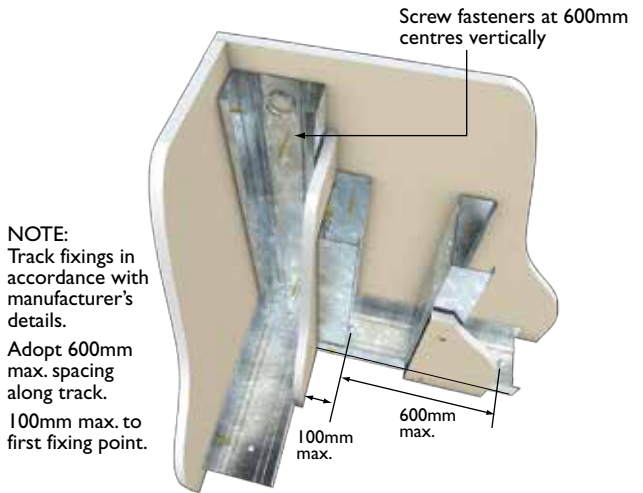

FIGURE 2: CORNER – SINGLE LAYER APPLICATION

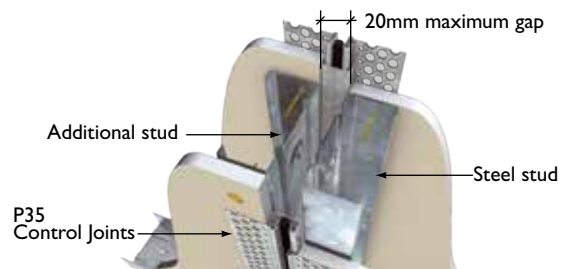

FIGURE 3: STUD WALL CONSTRUCTION WITH CONTROL JOINT

TABLE 1: Maximum Wall Heights

PLASTERBOARD LININGS		SINGLE STUDS @ 600mm CENTRES						
		0.50		0.55		0.75		
BMT		51mm	64mm	76mm	92mm	64mm	76mm	92mm
STUD WIDTH		51mm	64mm	76mm	92mm	64mm	76mm	92mm
LINED BOTH SIDES	1x10mm	2770	3330	3700	4540	3930	4430	4830
	1x13mm	3200	3720	4130	4940	4220	5020	5500
	1x16mm	3380	3910	4300	5180	4350	5250	5710
LINED ONE SIDE	1x10mm	2320	2720	3200	3610	3130	3580	4130
	1x13mm	2320	2720	3240	3610	3250	3820	4180
	1x16mm	2320	2720	3250	3610	3280	3870	4200

NOTE: These wall heights are not suitable for perimeter or external walls

TABLE 2: Nogging Requirements

WALL HEIGHT (m)	LINING	NO. OF NOGGINGS
0 – 4.4	Lined both sides	0
4.4 – 8.8		1
0 – 3.0	Lined one side	1
3.0 – 6.0		2
6.0 – 8.0		3
8.0+		4

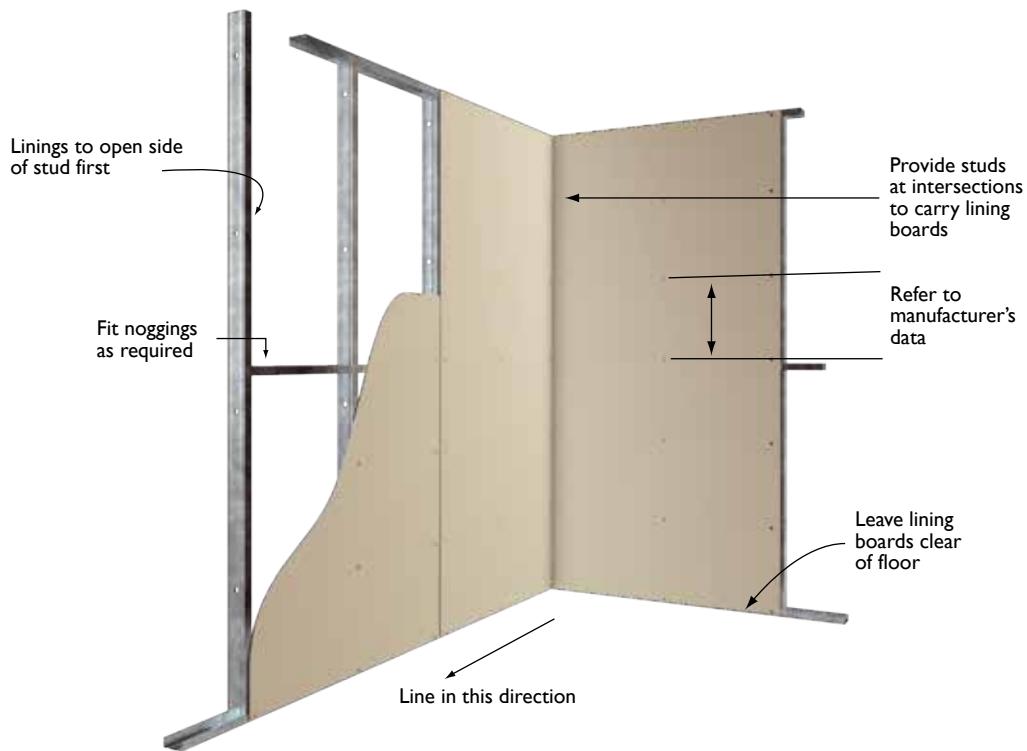

FIGURE 4: STUD WALL CONFIGURATION AND PLASTERBOARD FIXING DETAIL

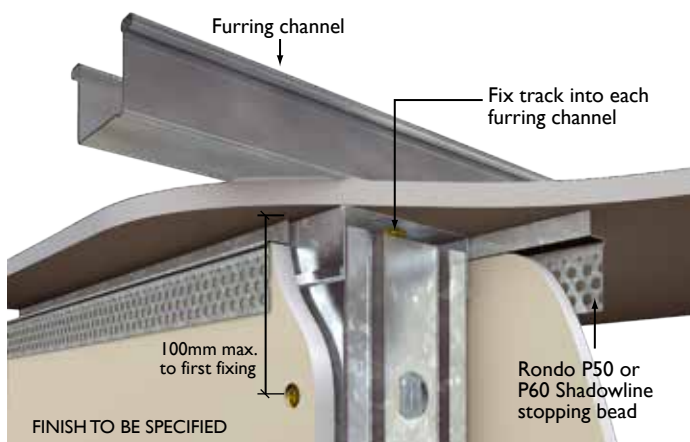

FIGURE 5A: WALL/CEILING INTERSECTION DETAIL WITH FRICTION FIT FOR SHADOWLINE APPLICATIONS

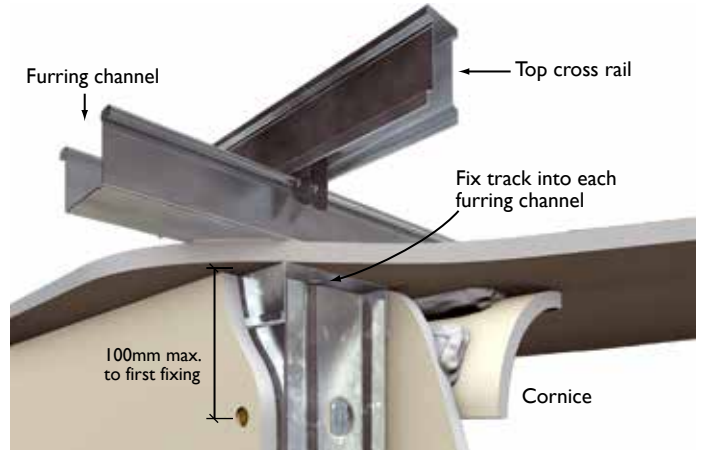

FIGURE 5B: WALL/CEILING INTERSECTION DETAIL WITH FRICTION FIT FOR CORNICE APPLICATIONS

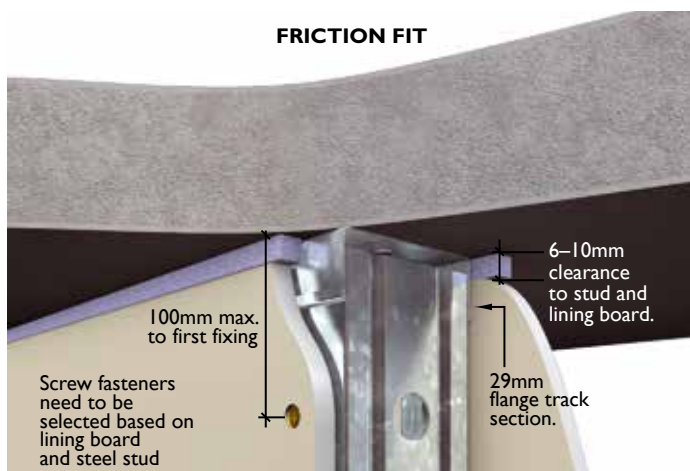

FIGURE 6A: FRICTION FIT APPLICATION

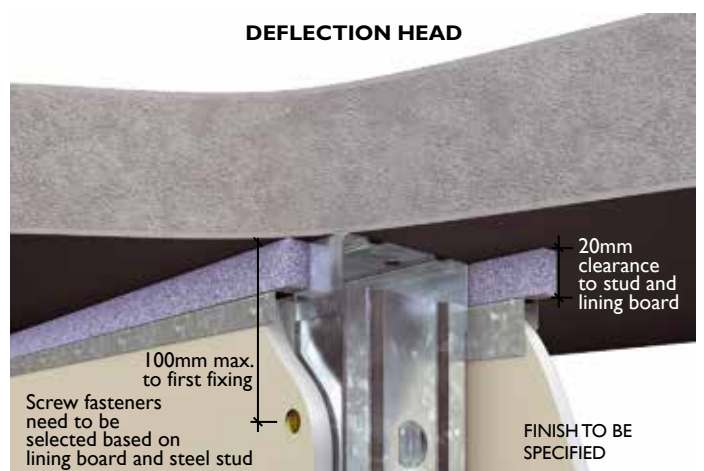

FIGURE 6B: DEFLECTION HEAD APPLICATION

NOTE: DO NOT RIGIDLY FIX CORNICE TO WALLS WHERE FRICTION JOINTS OR DEFLECTION HEADS ARE USED.

**INSTALLATION DETAILS: WINDOW & DOOR FRAMING**

Figure 7 details standard fixings suitable for window openings up to 1500mm and standard single leaf door openings. For configurations outside of these limits and external wall framings, consult your local Rondo office.

**Note:**

- Studs adjacent to window and door openings should be boxed and screw-fastened to the wall tracks and should be taken through to the structural soffit.
- Allow sufficient length on each end of the track to facilitate a suitable connection at the head or sill.
- Fit studs above and below the window openings and above the door openings as per Detail A.

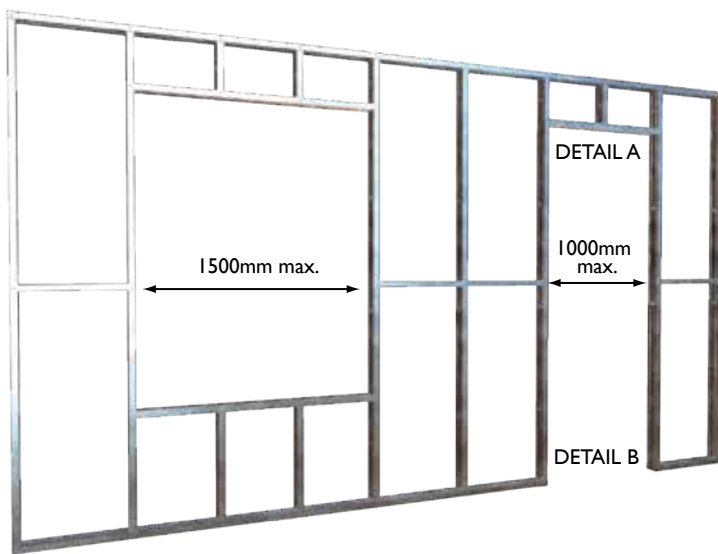
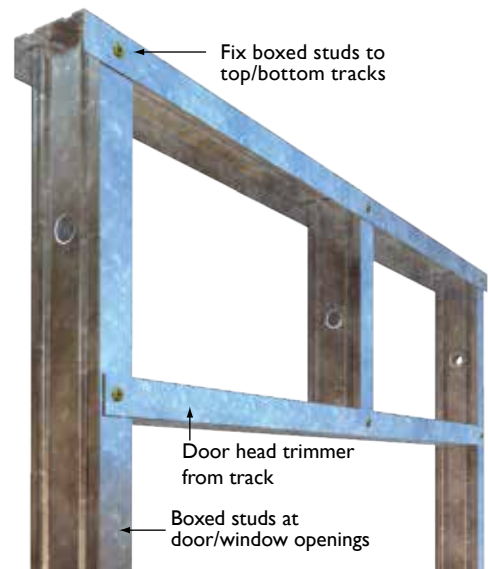
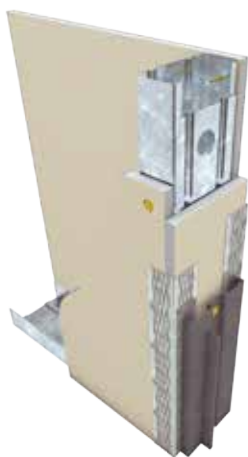

FIGURE 7: INTERNAL WALL FRAMING



DETAIL A: DOOR/WINDOW HEAD DETAIL



EXTRUDED ALUMINIUM DOOR JAMB PROFILE



TIMBER DOOR JAMB WITH STOPPING BEAD TO LINING BOARD

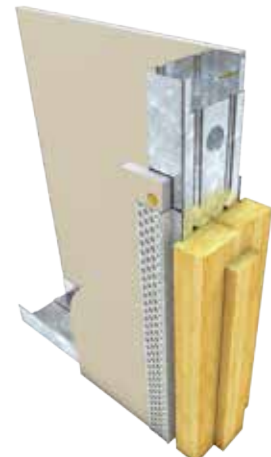

TIMBER DOOR JAMB WITH SHADOWLINE DETAIL

DETAIL B: VARIOUS DOOR JAMB DETAILS

*NOTE: This brochure provides a guide to basic drywall installation and the Rondo range. For solutions outside of the scope of this brochure, download the full Rondo Professional Design Manual from the Rondo website, or obtain a Rondo Professional Design USB from your local Authorised Rondo Distributor.*

*Rondo recommends that you seek professional advice in the selection of your system from your in-store sales consultant. Installation of complex or load-bearing wall systems should be undertaken by a qualified tradesperson.*

*The details in this brochure may not be suitable for fire-rated or acoustic applications, and Rondo recommends consulting a suitably qualified professional.*

# RONDO OFFICES

**AUSTRALIA: RONDO BUILDING SERVICES PTY LTD**  
CUSTOMER SERVICE HOTLINE: 1300-36-RONDO (1300-36-7663)

**NEW SOUTH WALES**  
57-87 Lockwood Road Erskine Park NSW 2759  
(PO Box 324 St Marys NSW 1790)  
phone: 61-2-9912 7300 fax: 61-2-9912 7310 email: [nsw@rondo.com.au](mailto:nsw@rondo.com.au)

**VICTORIA**  
12-14 Dunlop Road Mulgrave VIC 3170  
(Private Bag 23 Mulgrave VIC 3170)  
phone: 61-3-8561 2222 fax: 61-3-8561 2266 email: [vic@rondo.com.au](mailto:vic@rondo.com.au)

**QUEENSLAND**  
13 Binary Street Yatala QLD 4207  
(PO Box 6006 Yatala QLD 4207)  
phone: 61-7-3442 6400 fax: 61-7-3442 6427 email: [qld@rondo.com.au](mailto:qld@rondo.com.au)

**SOUTH AUSTRALIA**  
39 George Street Green Fields SA 5107  
phone: 61-8-8256 5900 fax: 61-8-8256 5922 email: [sa@rondo.com.au](mailto:sa@rondo.com.au)

**WESTERN AUSTRALIA**  
5 Hazelhurst Street Kewdale WA 6105  
(PO Box 168 Cloverdale WA 6985)  
phone: 61-8-9251 9400 fax: 61-8-9251 9414 email: [wa@rondo.com.au](mailto:wa@rondo.com.au)

**HEAD OFFICE**  
57-87 Lockwood Road Erskine Park NSW 2759  
(PO Box 324 St Marys NSW 1790)  
phone: 61-2-9912 7300 fax: 61-2-9912 7310 email: [rondo@rondo.com.au](mailto:rondo@rondo.com.au)

**EXPORT** phone: 61-438-427-479 fax: 61-7-3287-1881 email: [export@rondo.com.au](mailto:export@rondo.com.au)

**NEW ZEALAND: RONDO BUILDING SERVICES PTY LTD**  
FREE CALL: 0800-0800-RONDO (0800-0800-76)  
[www.rondo.co.nz](http://www.rondo.co.nz)

**AUCKLAND**  
117 Captain Springs Road Onehunga  
Auckland 1061  
(PO Box 12464 Penrose Auckland 1642)  
phone: 64-9-636 5110 fax: 64-9-636 5111 email: [rondo.newzealand@rondo.co.nz](mailto:rondo.newzealand@rondo.co.nz)

**CHRISTCHURCH**  
106 F Carmen Road Hornby Christchurch 8042  
phone: 64-3-421 7840 fax: 64-9-636 5111

**MALAYSIA: RONDO METAL PRODUCTS SDN BHD**  
Lot 606, off Jalan SS13/1K  
47500 Subang Jaya Selangor  
phone: 60-3-5636 0710 fax: 60-3-5636 0711 email: [rondo.malaysia@rondo.com.my](mailto:rondo.malaysia@rondo.com.my)  
[www.rondo.asia](http://www.rondo.asia)

**UAE: RONDO METAL PRODUCTS SDN BHD**  
Al Saraya Avenue Building Al Garhoud Dubai UAE  
(PO Box 14424 Dubai UAE)  
phone: 971-505-511-893

**INDIA: RONDO METAL SYSTEMS PVT LTD**  
Plot J-21, MIDC Talaja, Tal, Panvel  
Dist Raigad - 410 208 Mumbai India  
phone: 91-22-2740 2831 email: [rondo.india@rondo.co.in](mailto:rondo.india@rondo.co.in)  
[www.rondo.co.in](http://www.rondo.co.in)

# RONDO®

[www.rondo.com.au](http://www.rondo.com.au)